

圖例

- LEGEND:
- 施工區界限(在擬建的地面水平之下)  
LIMIT OF WORKS AREA (BELOW PROPOSED GROUND LEVEL)
  - 擬建行車道(在擬建的地面水平之下)  
PROPOSED CARRIAGEWAY (BELOW PROPOSED GROUND LEVEL)
  - 擬建行人路(在擬建的地面水平之下)  
PROPOSED FOOTPATH (BELOW PROPOSED GROUND LEVEL)
  - 擬建上落客區(在擬建的地面水平之下)  
PROPOSED PICK-UP / DROP-OFF AREA (BELOW PROPOSED GROUND LEVEL)
  - 擬建行人過路處(在擬建的地面水平之下)  
PROPOSED PEDESTRIAN CROSSING (BELOW PROPOSED GROUND LEVEL)
  - 擬建中央分隔帶/安全島(在擬建的地面水平之下)  
PROPOSED CENTRAL MEDIAN / TRAFFIC ISLAND (BELOW PROPOSED GROUND LEVEL)
  - 行車方向(在擬建的地面水平之下)  
TRAFFIC DIRECTION (BELOW PROPOSED GROUND LEVEL)
  - (+5.7) 建議水平(約數)  
PROPOSED LEVEL (APPROXIMATE)

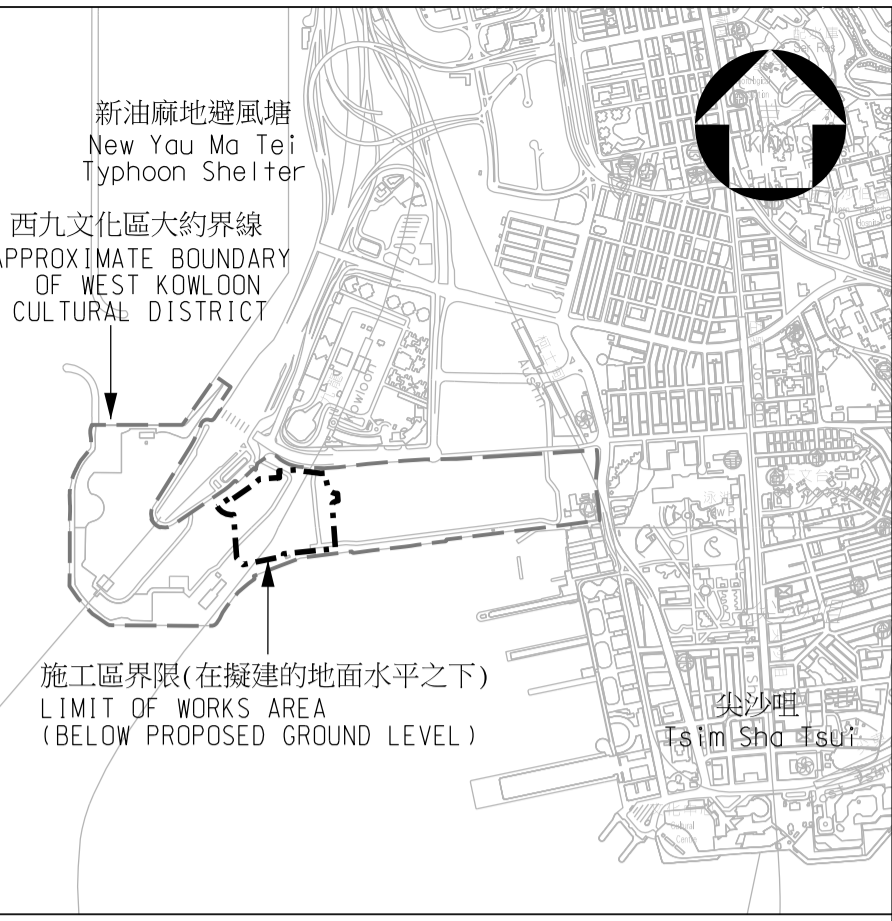
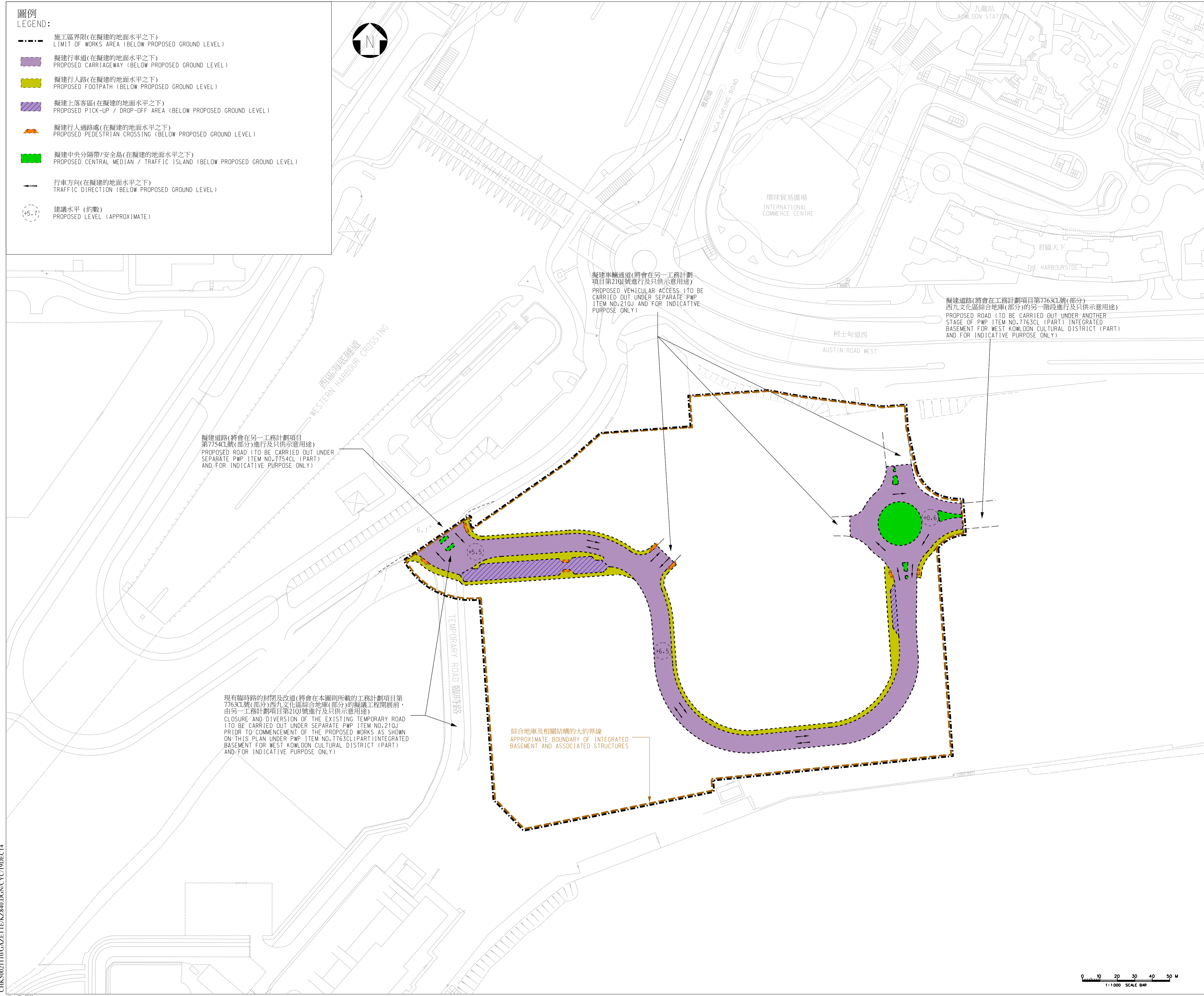

位置圖  
LOCATION PLAN  
比例 SCALE 1:20000

註釋  
NOTES:

- 除在其他方面指定外,所有以米為量度單位。  
ALL DIMENSIONS ARE IN METRES UNLESS OTHERWISE STATED.
- 所有水平均為約數,以米為單位,並基於香港主水平基準上。  
ALL LEVELS ARE APPROXIMATE VALUES AND IN METRES ABOVE HONG KONG PRINCIPAL DATUM.

批註  
ENDORSED BY

黎以德 JOSEPH Y T LAI SIGNED

運輸及房屋局常任秘書長(運輸)  
PERMANENT SECRETARY FOR TRANSPORT AND HOUSING (TRANSPORT)

3 Feb 2015  
日期  
DATE

核准  
APPROVED BY

莫永昌 MOK WING CHEONG SIGNED

署理土木工程拓展署總工程師/九龍5(九龍)  
ACTING CHIEF ENGINEER /KOWLOON 5 (KOWLOON)  
CIVIL ENGINEERING AND DEVELOPMENT DEPARTMENT

2 Feb 2015  
日期  
DATE

版權所有 不得翻印  
COPYRIGHT RESERVED

工程名稱 project title

工務計劃項目第7763CL號(部分)  
西九文化區綜合地庫(部分)  
PWP ITEM NO. 7763CL (PART)  
INTEGRATED BASEMENT FOR WEST KOWLOON CULTURAL DISTRICT (PART)

圖則名稱 plan title

根據《道路(工程、使用及補償)條例》(第370章)而在憲報公布之圖則  
PLAN FOR GAZETTING UNDER ROADS (WORKS, USE AND COMPENSATION) ORDINANCE (CHAPTER 370)

圖則編號 plan no. KZ840 比例 scale 1:1000 @ A1

辦事處 office  
九龍拓展處  
KOWLOON DEVELOPMENT OFFICE

CEDD 土木工程拓展署  
CIVIL ENGINEERING AND DEVELOPMENT DEPARTMENT

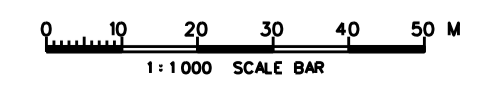

CHK50021100GAZETTE/KZ840.DGN/CYC/19DBE14