

位置 LOCATION

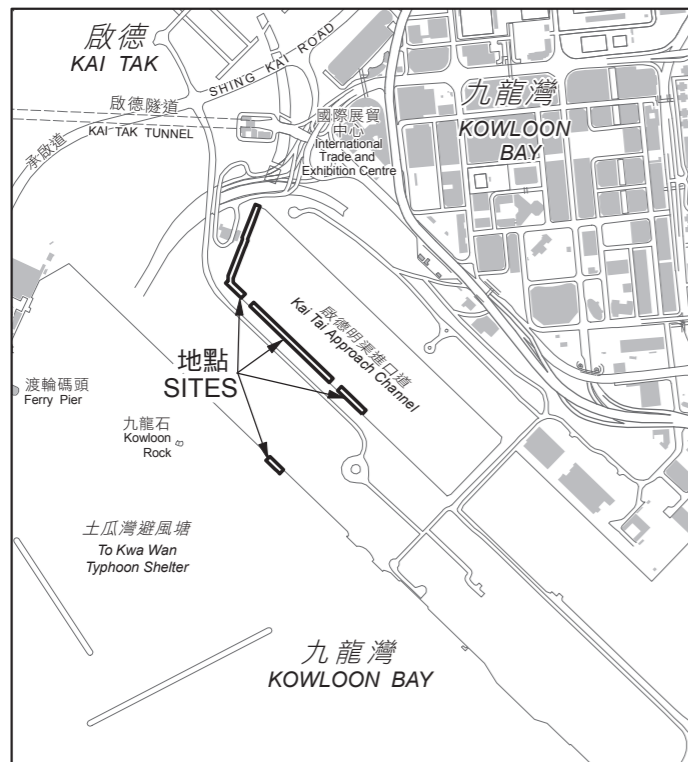

比例 SCALE 1:20 000

圖例 LEGEND

受影響的前濱及海床範圍
FORESHORE AND SEA-BED AFFECTED

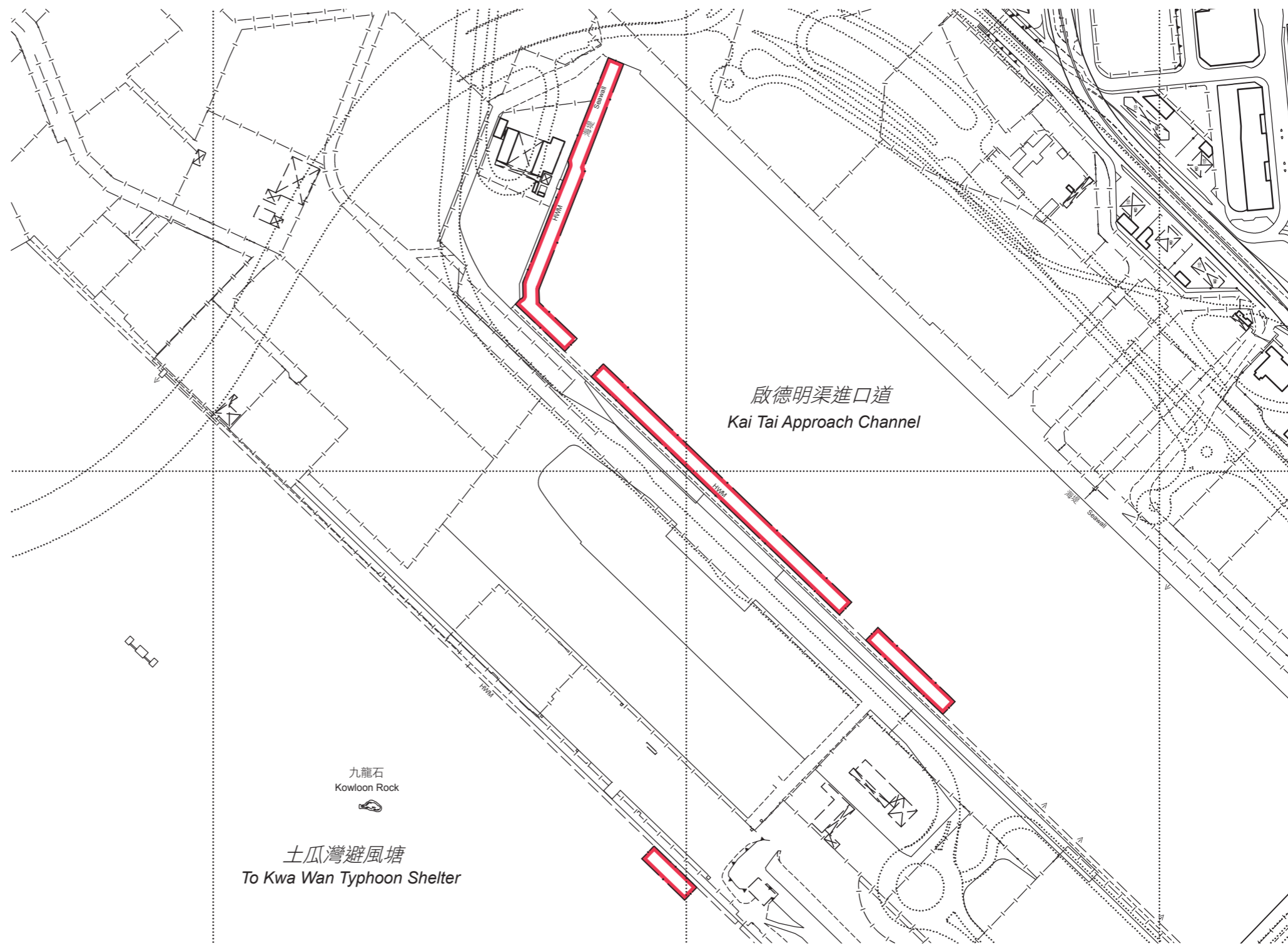

以紅色邊線標示的面積約為 10 400 平方米 EDGED RED AREA 10 400 SQUARE METRES (ABOUT)

比例尺 SCALE 1:4 000

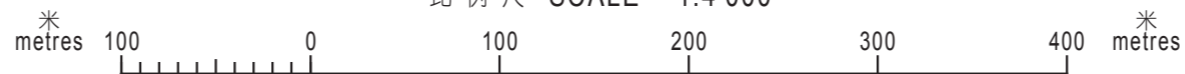

副署長(專業事務) Deputy Director / Specialist

地政總署
Lands Department

圖則由九龍測量處繪製
Plan Prepared by District Survey Office, Kowloon

© 香港特別行政區政府 版權所有 Copyright reserved - Hong Kong SAR Government

前濱及海床(填海工程)條例(第127章)
工務計劃項目第7702CL號(部分)
啟德發展計劃 - 前跑道及南面停機坪第四期基礎設施
在啟德前跑道建造海濱長廊及海水進水口

FORESHORE AND SEA-BED (RECLAMATIONS) ORDINANCE (CHAPTER 127)
PUBLIC WORKS PROGRAMME ITEM NO. 7702CL (PART)

KAI TAK DEVELOPMENT - STAGE 4 INFRASTRUCTURE AT THE FORMER RUNWAY AND SOUTH APRON
CONSTRUCTION OF WATERFRONT PROMENADE AND SEAWATER INTAKE POINT AT FORMER KAI TAK RUNWAY

檔案編號 File No. DSO/K W654/1 IV

測量圖編號 Survey Sheet No. 11-NE-16B,16D,17A&17C

發展藍圖編號 Layout Plan No. ---

參考圖編號 Reference Plan No. ---

圖則編號 PLAN No. KM9910

日期 Date: 05/12/2017