

**TYPICAL SECTION**

NTS

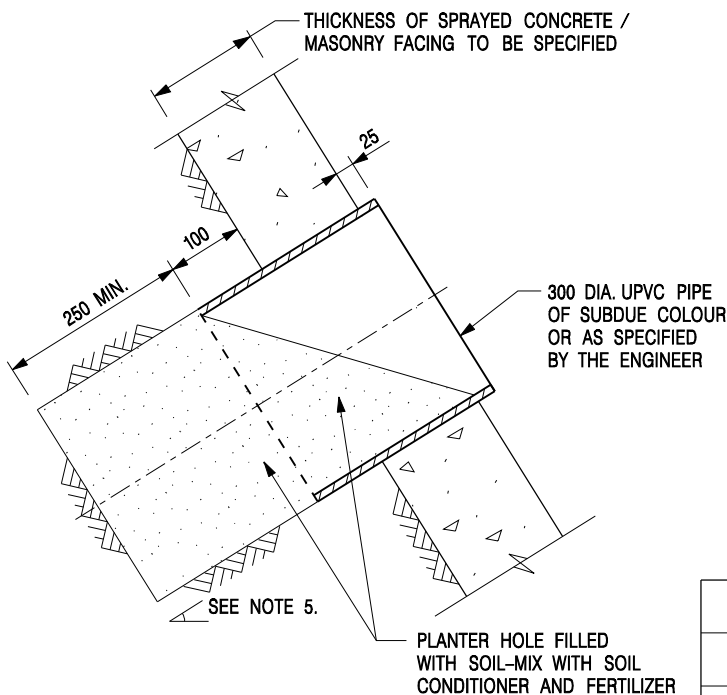

**DETAIL 'X'**

SCALE 1 : 10

**NOTES:**

1. ALL DIMENSIONS ARE IN MILLIMETRES.
2. THE ENGINEER SHALL SPECIFY THE SPECIES OF CLIMBER.
3. SPECIFICATIONS FOR THE SOIL-MIX, SOIL CONDITIONER AND FERTILIZER ARE GIVEN IN SECTION 3 OF THE GENERAL SPECIFICATION.
4. THE ENGINEER SHALL SPECIFY THE SPACING AND DIAMETER OF THE PLANTER HOLES. TYPICAL SPACING OF THE PLANTER HOLE IS 1500 mm TO 2000 mm STAGGERED, AND TYPICAL DIAMETER OF THE UPVC PIPE IS 300 mm.
5. THE INCLINATION OF UPVC PIPE SHALL BE PERPENDICULAR TO THE SLOPE SURFACE FOR SLOPES EQUAL TO OR LESS THAN 60° OR MIN. 30° FOR SLOPES STEEPER THAN 60°.

E	SPACING AND DETAILS OF PLANTER HOLE REVISED	Original Signed	09.2013
D	TITLE AMENDED AND GENERAL AMENDMENT.	Original Signed	02.2011
C	GENERAL AMENDMENT.	Original Signed	02.2007
B	PLANTER HOLE DIA. AMENDED.	Original Signed	11.2006
A	NAME OF DEPARTMENT AMENDED.	Original Signed	01.2005
-	NEW ISSUE.	Original Signed	12.2002
<b>REF.</b>	<b>REVISION</b>	<b>SIGNATURE</b>	<b>DATE</b>

PLANTER HOLE FOR SPRAYED CONCRETE / MASONRY FACING SLOPE



**CIVIL ENGINEERING AND DEVELOPMENT DEPARTMENT**

**SCALE** AS SHOWN

**DRAWING NO.**

**DATE** DEC 2002

**C2507E**