

T (MIN.) = 200 (T PREFERRED 300)  
 R (MAX.) = 200  
 $R = T \times \tan \theta$   
 $T \times R = 50\ 000$  APPROX.

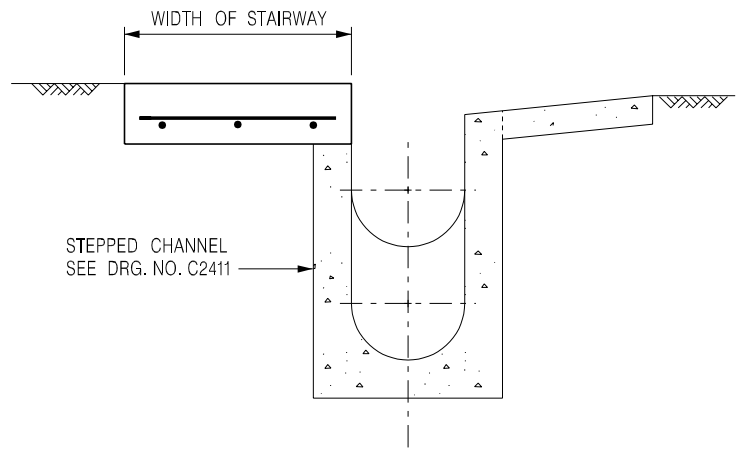

CROSS SECTION OF COMBINED STAIRWAY & STEPPED CHANNEL

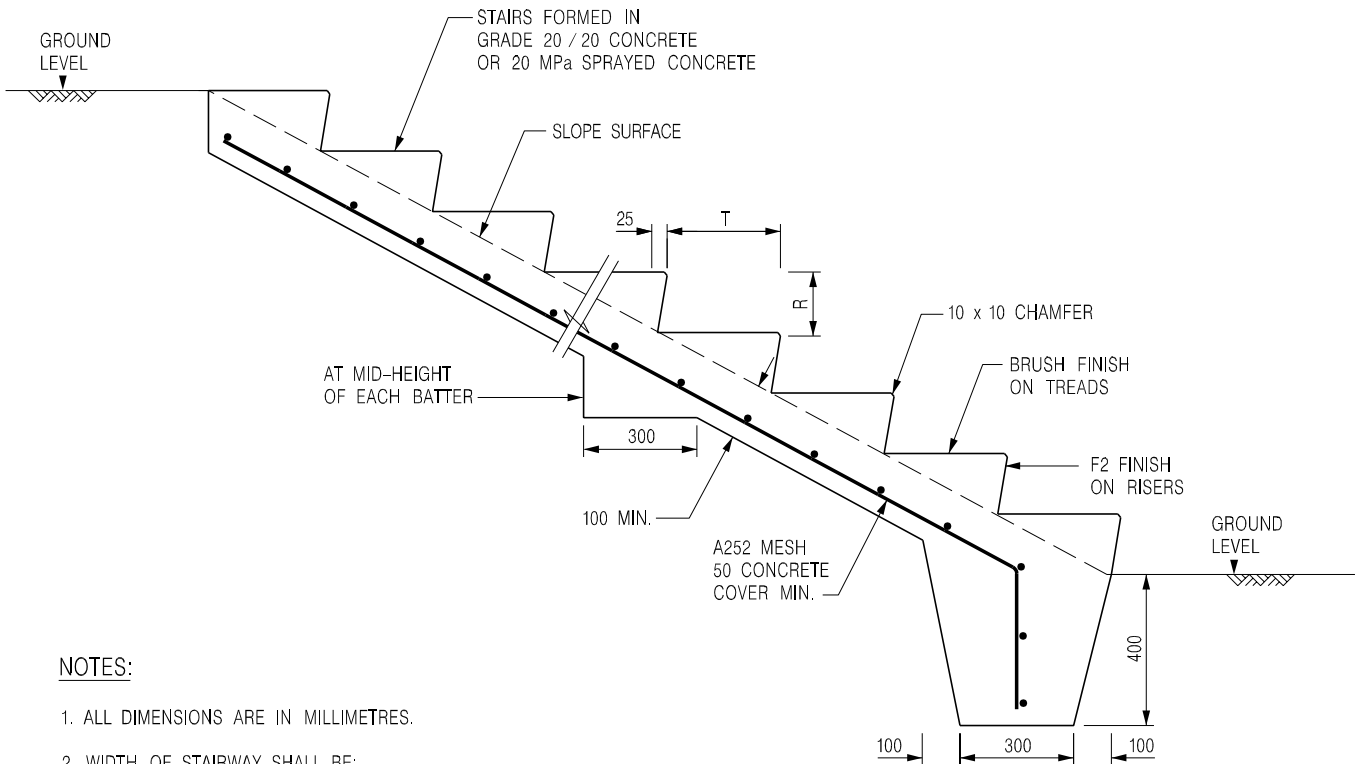

**NOTES:**

1. ALL DIMENSIONS ARE IN MILLIMETRES.
2. WIDTH OF STAIRWAY SHALL BE: 600 mm MIN. WITH SINGLE HANDRAIL (SEE STD. DRG. NO. C2103) OR SPECIFIED ON DRAWINGS.
3. HANDRAIL TO BE INSTALLED ON DOWNHILL SIDE OF STAIRWAY.
4. MINIMUM LAP LENGTH OF 320 mm FOR A252 MESH SHALL BE PROVIDED.

D	DRAWING TITLE AMENDED. MINOR AMENDMENT.	Original Signed	02.2008
C	NAME OF DEPARTMENT AMENDED.	Original Signed	01.2005
B	NOTE 4 ADDED.	Original Signed	01.2004
A	GENERAL REVISION.	Original Signed	12.2002
<b>REF.</b>	<b>REVISION</b>	<b>SIGNATURE</b>	<b>DATE</b>

**DIMENSIONS FOR CONCRETE MAINTENANCE STAIRWAY ON SLOPES UP TO 40°**



**CIVIL ENGINEERING AND DEVELOPMENT DEPARTMENT**

**SCALE** 1 : 20

**DRAWING NO.**

**DATE** JAN 1991

**C2101D**