

CAD REF.: P:\CN\HA\Project\5208968\_GAZ-2003\TWS\2010\CAD\2010\Drawing\5208968-GAZ-2003.dgn  
50  
SSplotterSS  
SSpentab1SS  
SSdgnfileSS  
A1 841x594

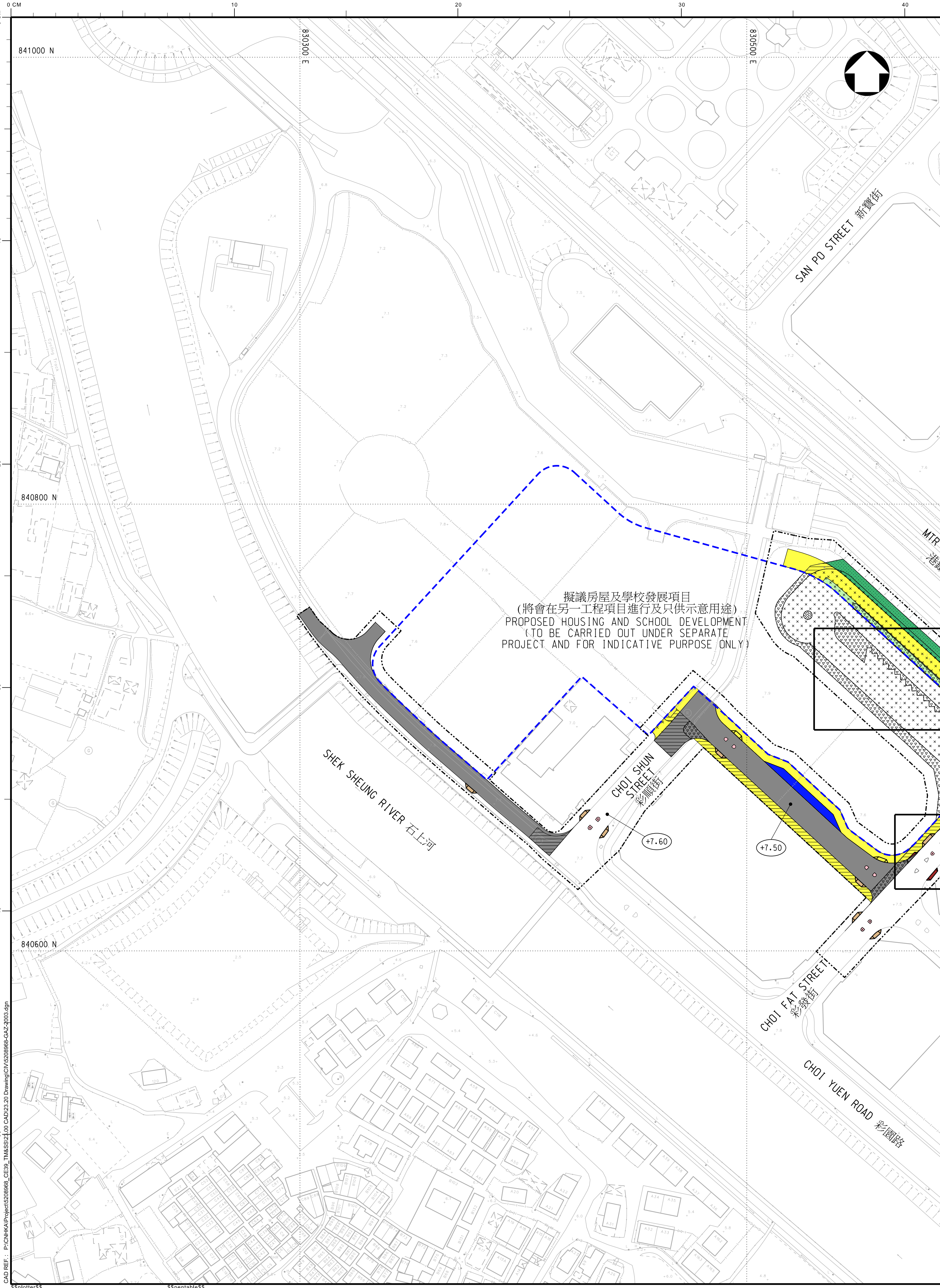

**圖例 LEGEND:**

--- 施工區界限 LIMIT OF WORKS AREA	現有行人路將永久封閉並改建為美化市容地帶 EXISTING FOOTPATH TO BE PERMANENTLY CLOSED AND CONVERTED INTO AMENITY AREA
擬建行車道 PROPOSED CARRIAGEWAY	現有行人路將永久封閉並改建為行人過路處 EXISTING FOOTPATH TO BE PERMANENTLY CLOSED AND CONVERTED INTO PEDESTRIAN CROSSING
擬建行人路 PROPOSED FOOTPATH	現有行人路將永久封閉並改建為車輛進出口通道 EXISTING FOOTPATH TO BE PERMANENTLY CLOSED AND CONVERTED INTO VEHICULAR RUN-IN/RUN-OUT
擬建行人過路處 PROPOSED PEDESTRIAN CROSSING	現有行人過路處將永久封閉並改建為行車道 EXISTING PEDESTRIAN CROSSING TO BE PERMANENTLY CLOSED AND CONVERTED INTO CARRIAGEWAY
擬建安全島 PROPOSED TRAFFIC ISLAND	現有行人過路處將永久封閉並改建為行人路 EXISTING PEDESTRIAN CROSSING TO BE PERMANENTLY CLOSED AND CONVERTED INTO FOOTPATH
擬建停車灣 PROPOSED LAY-BY	現有安全島將永久封閉並改建為行車道 EXISTING TRAFFIC ISLAND TO BE PERMANENTLY CLOSED AND CONVERTED INTO CARRIAGEWAY
現有行車道將永久封閉並改建為行人路 EXISTING CARRIAGEWAY TO BE PERMANENTLY CLOSED AND CONVERTED INTO FOOTPATH	現有行車道將永久封閉及拆卸 EXISTING CARRIAGEWAY TO BE PERMANENTLY CLOSED AND DEMOLISHED
現有行車道將永久封閉並改建為有蓋行人路 EXISTING CARRIAGEWAY TO BE PERMANENTLY CLOSED AND CONVERTED INTO COVERED FOOTPATH	現有行人路將永久封閉及拆卸 EXISTING FOOTPATH TO BE PERMANENTLY CLOSED AND DEMOLISHED
現有行車道將永久封閉並改建為美化市容地帶 EXISTING CARRIAGEWAY TO BE PERMANENTLY CLOSED AND CONVERTED INTO AMENITY AREA	現有安全島將永久封閉及拆卸 EXISTING TRAFFIC ISLAND TO BE PERMANENTLY CLOSED AND DEMOLISHED
現有行車道將永久封閉並改建為安全島 EXISTING CARRIAGEWAY TO BE PERMANENTLY CLOSED AND CONVERTED INTO TRAFFIC ISLAND	現有行車道將暫時封閉及重建 EXISTING CARRIAGEWAY TO BE TEMPORARILY CLOSED AND RECONSTRUCTED
現有行車道將永久封閉並改建為車輛進出口通道 EXISTING CARRIAGEWAY TO BE PERMANENTLY CLOSED AND CONVERTED INTO VEHICULAR RUN-IN/RUN-OUT	現有行人路將暫時封閉及重建 EXISTING FOOTPATH TO BE TEMPORARILY CLOSED AND RECONSTRUCTED
現有行人路將永久封閉並改建為行車道 EXISTING FOOTPATH TO BE PERMANENTLY CLOSED AND CONVERTED INTO CARRIAGEWAY	擬議房屋及學校發展項目界限 (將會在另一工程項目進行及只供示意用途) BOUNDARY OF PROPOSED HOUSING AND SCHOOL DEVELOPMENT (TO BE CARRIED OUT UNDER SEPARATE PROJECT AND FOR INDICATIVE PURPOSE ONLY)
現有行人路將永久封閉並改建為有蓋行人路 EXISTING FOOTPATH TO BE PERMANENTLY CLOSED AND CONVERTED INTO COVERED FOOTPATH	建議水平(約數) PROPOSED LEVEL (APPROXIMATELY)

建議水平(約數)  
PROPOSED LEVEL (APPROXIMATELY)  
+7.60

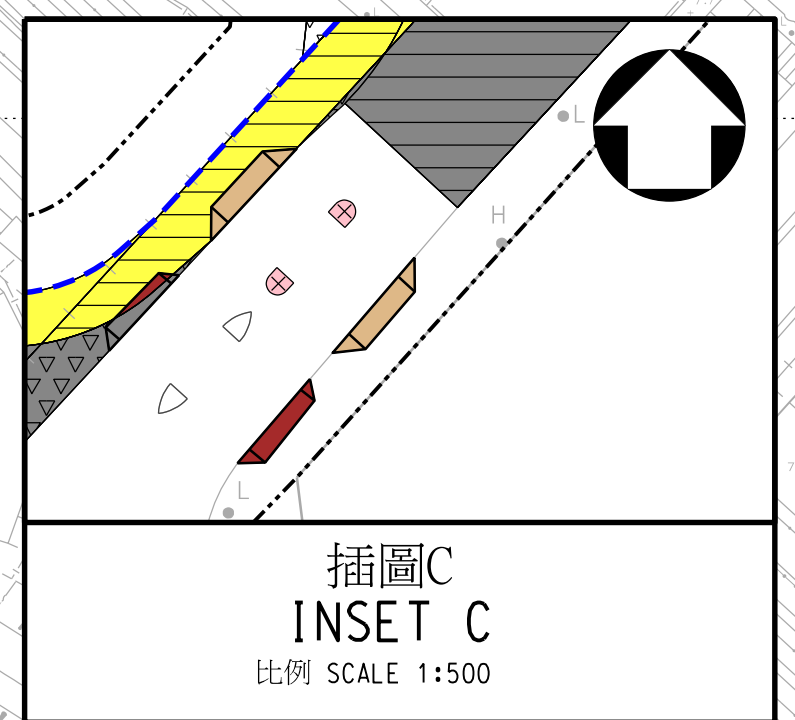
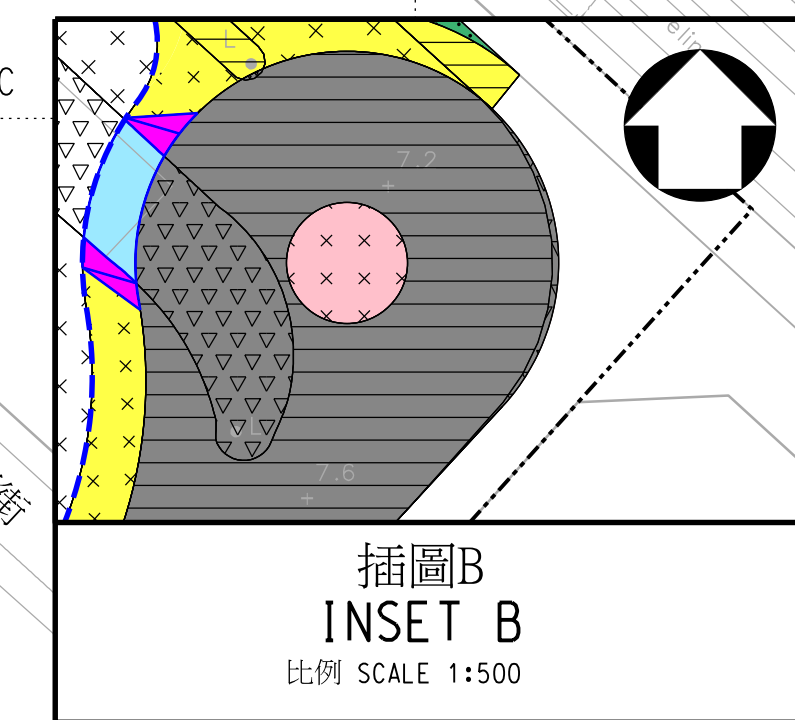
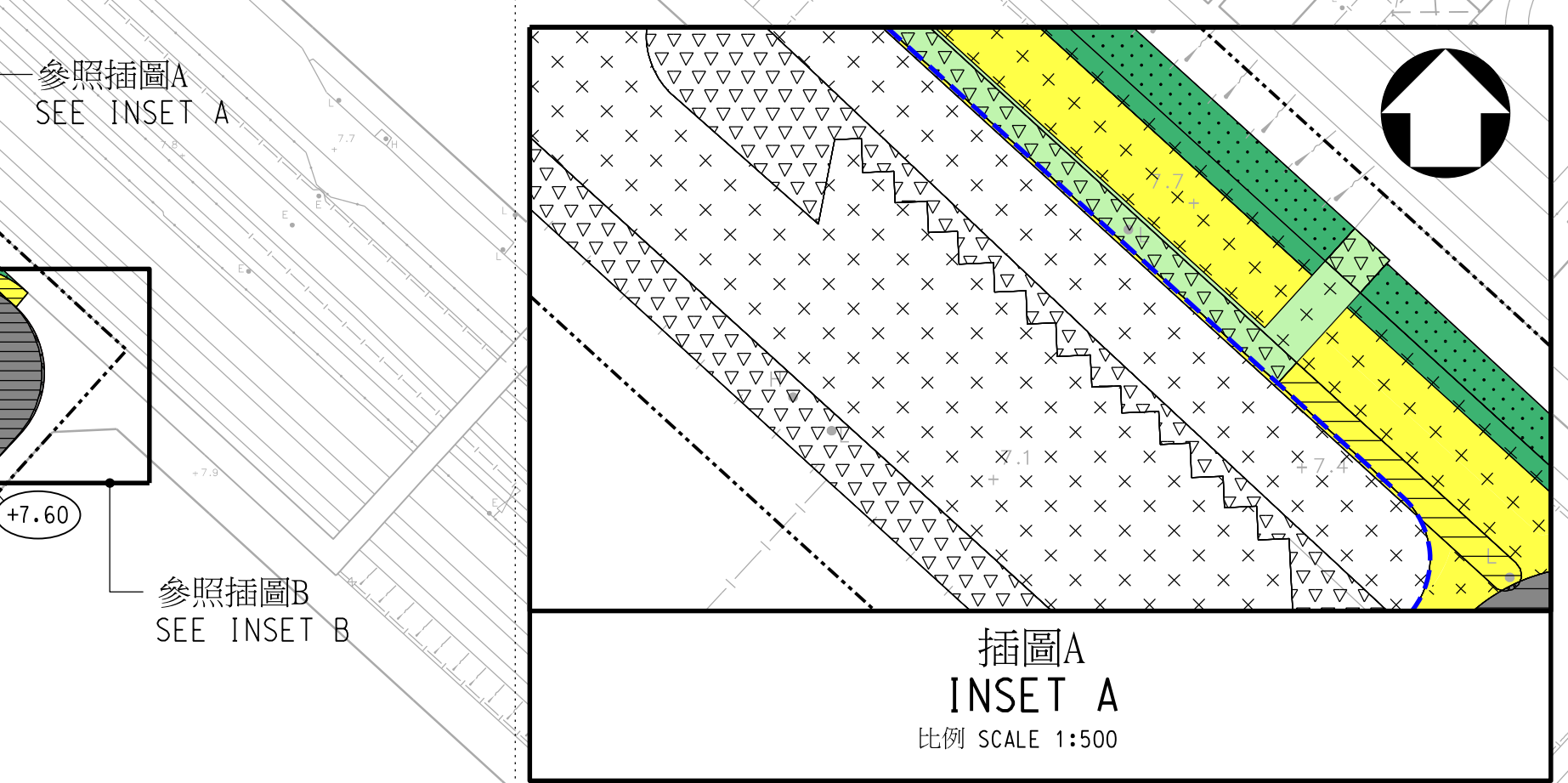

**位置圖 LOCATION PLAN**  
比例 SCALE 1:15000

註釋 NOTES:

- 除另有說明外，所有量度以米為單位。  
ALL DIMENSIONS ARE IN METERS UNLESS OTHERWISE STATED.
- 所有水平均為約數，以米為單位，並在香港主水平基準上。  
ALL LEVELS ARE IN APPROXIMATE VALUES AND IN METRES ABOVE HONG KONG PRINCIPAL DATUM.
- 如有需要，施工區界限內部分現有行車道、行人路、行人過路處、安全島及停車灣或會分階段暫時封閉。  
SECTIONS OF THE EXISTING CARRIAGEWAYS, FOOTPATHS, PEDESTRIAN CROSSINGS, TRAFFIC ISLANDS AND LAY-BYS WITHIN THE LIMIT OF WORKS AREA MAY BE TEMPORARILY CLOSED IN PHASES AS AND WHEN REQUIRED.

批註 ENDORSED BY

陳美寶 CHAN Mable  
運輸及物流局常任秘書長  
PERMANENT SECRETARY  
FOR TRANSPORT AND LOGISTICS  
日期 DATE: 03 OCT 2022

核准 APPROVED BY

薛鳳聲 F S SIT  
總工程師 / 房屋工程3  
土木工程處  
土木工程拓展署  
CHIEF ENGINEER / HOUSING PROJECTS 3  
CIVIL ENGINEERING OFFICE  
CIVIL ENGINEERING AND DEVELOPMENT DEPARTMENT  
日期 DATE: 26 SEP 2022

工程名稱 PROJECT TITLE  
工務計劃項目第B850CL號  
上水彩順街公營房屋發展之  
工地平整及基礎設施工程  
PWP ITEM NO. B850CL  
SITE FORMATION AND INFRASTRUCTURE  
WORKS FOR PUBLIC HOUSING  
DEVELOPMENT AT CHOI SHUN STREET,  
SHEUNG SHUI

圖則名稱 PLAN TITLE

根據《道路(工程、使用及補償)條例》  
(第370章)而在憲報公布的圖則  
PLAN FOR GAZETTING UNDER ROADS  
(WORKS, USE AND COMPENSATION)  
ORDINANCE (CHAPTER 370)

圖則編號 PLAN NO. 5208968-GAZ-2003 比例 SCALE 1:1000 (A1)

部門 OFFICE  
土木工程處 房屋工程3部  
HOUSING PROJECTS 3 DIVISION  
CIVIL ENGINEERING OFFICE

土木 Engineering and  
Development Department