

Filename: J:\250269\Arup\CIVIL\SKETCH\Report\250269_GZ_011.dgn

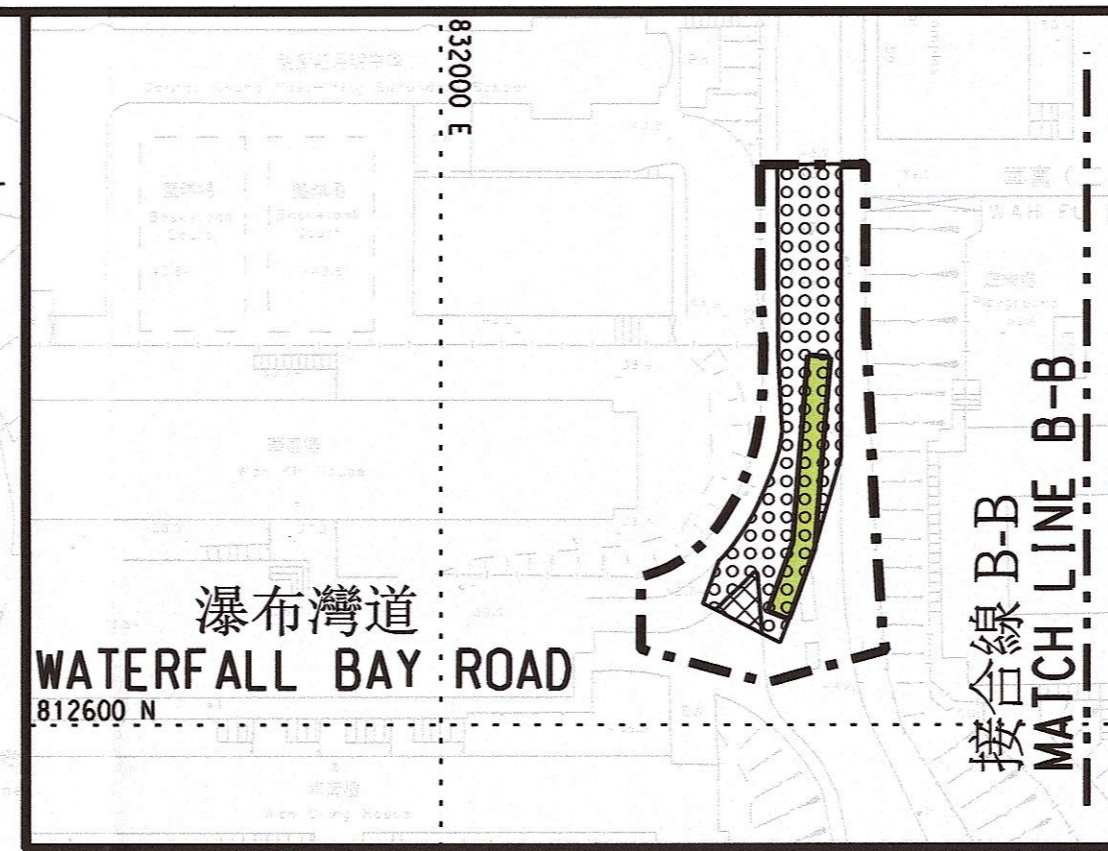

圖例 LEGEND

	施工區界限 LIMIT OF WORKS AREA
	擬敷設無壓污水管及相關的沙井之範圍 PROPOSED AREA WITHIN WHICH GRAVITY SEWERS AND ASSOCIATED MANHOLES TO BE LAID
	現有行人路將予臨時封閉並將其恢復原貌 EXISTING FOOTPATH TO BE TEMPORARILY CLOSED AND REINSTATED
	現有的行車道將予臨時封閉並將其恢復原貌 EXISTING CARRIAGEWAYS TO BE TEMPORARILY CLOSED AND REINSTATED

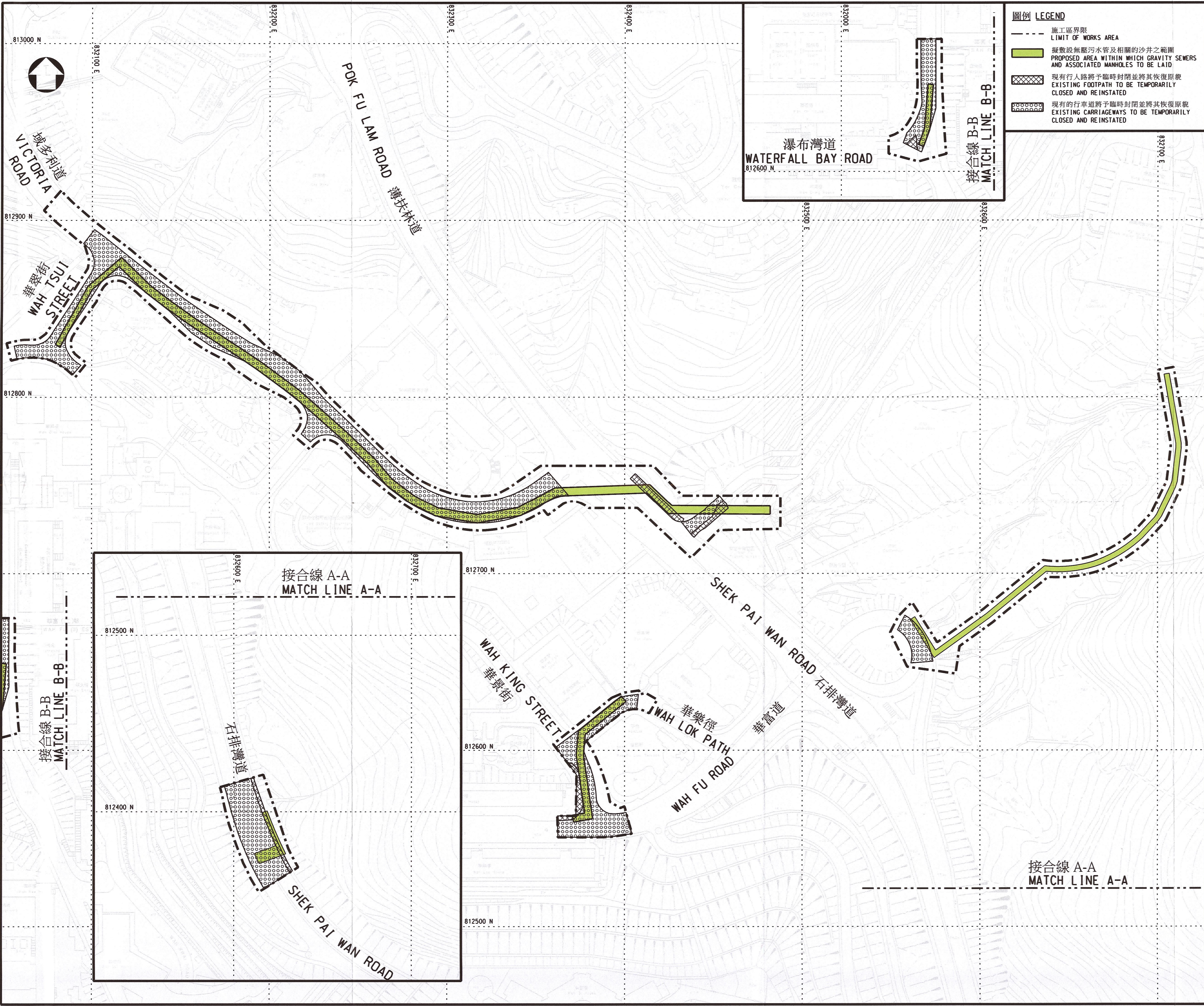
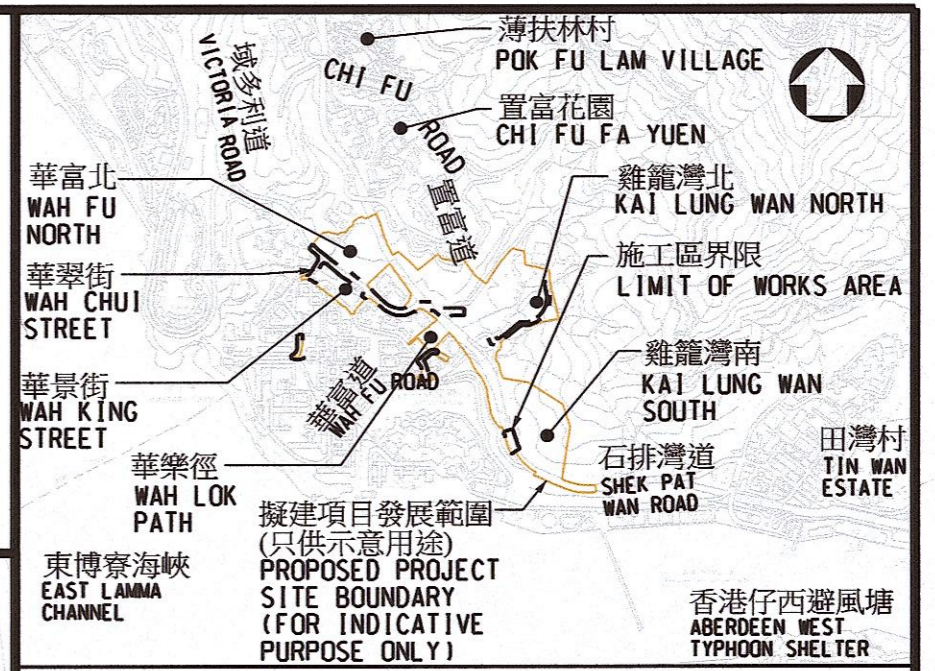

位置圖 LOCATION PLAN
比例 SCALE 1:20000

- 註釋 NOTES**
- 除在其他方面指定外，所有量度以米為單位。
ALL DIMENSIONS ARE IN METRES
UNLESS OTHERWISE STATED.
 - 所有水平均為約數，以米為單位，並在香港主
水平基準上。
ALL LEVELS ARE APPROXIMATE VALUES AND IN
METRES ABOVE HONG KONG PRINCIPAL DATUM
 - 如有需要，施工區界限內部分現有的行車道，行人路，
停車灣和中央分隔帶/安全島或將分階段暫時封閉。
SECTIONS OF THE EXISTING CARRIAGEWAYS, FOOTPATHS,
LAY-BYS AND CENTRAL MEDIANS / TRAFFIC ISLANDS
WITHIN THE LIMIT OF WORKS AREA MAY BE TEMPORARILY
CLOSED IN PHASES AS AND WHEN REQUIRED.

批簽 ENDORSED BY

廖為良 *Ricky L* RICKY W L LIU
高級環境保護主任 (排污基建)
SENIOR ENVIRONMENTAL PROTECTION OFFICER
(SEWERAGE INFRASTRUCTURE)
ENVIRONMENTAL PROTECTION DEPARTMENT

日期: 17 SEP 2018
DATE:

核准 APPROVED BY

薛鳳聲 *F S* F S SIT
總工程師/房屋工程3
土木工程處
土木工程拓展署
CHIEF ENGINEER / HOUSING PROJECTS 3
CIVIL ENGINEERING OFFICE
CIVIL ENGINEERING AND DEVELOPMENT DEPARTMENT

日期: 06 SEP 2018
DATE:

工程名稱 PROJECT TITLE
工務計劃項目第B795CL號
薄扶林南公營房屋發展之
工地平整及基礎設施工程
PWP ITEM NO. B795CL
SITE FORMATION AND INFRASTRUCTURE WORKS
FOR PUBLIC HOUSING DEVELOPMENTS AT
POK FU LAM SOUTH

圖則名稱 DRAWING TITLE
根據《水污染管制(排污設備)規例》
(第358章附屬法例 AL) 第26條引用
而在憲報公佈之圖則

PLANS FOR GAZETTE UNDER SECTION 26
OF THE WATER POLLUTION CONTROL
(SEWERAGE) REGULATION
(CHAPTER 358 SUBSIDIARY LEGISLATION AL)

圖則編號 PLAN NO.	比例 SCALE
GZ/011	1:1000 (A1)

辦事處 OFFICE
土木工程處 房屋工程3部
HOUSING PROJECTS 3 DIVISION
CIVIL ENGINEERING OFFICE

土木工程拓展署
Civil Engineering and
Development Department